

**VACUUM
SERIES
INSTRUCTION
MANUAL**

E-WARRANTY



SCAN HERE

Russell Taylors



Safety Instructions

Warning : Basic safety precautions should always be observed when using an electrical appliance, including the following to reduce the risk of fire, electrical shock or injury.

- Store the vacuum in a dry place out of reach of children.
- The appliance is not intended for use by persons (including children) with reduced physical, sensory or mental capabilities, or lack of experience and knowledge, unless they have been given supervision or instruction concerning the use of this appliance by a person responsible to their safety.
- Children must be supervised to ensure that they do not play with the appliance.
- Use only the attachments provided in the packaging. Any misuse or use of any accessory or attachment that was not provided by Russell Taylors may present a risk of personal injury.
- Keep the appliance and accessories away from hot surfaces.
- Do not block the appliance openings or hinder air flow. Keep the openings free of any objects including dust, lint, clothing and fingers.

Electrical Safety

- Only use the battery and charger supplied in the original packaging, The appliance is only to be used with the power supply unit provided in the packaging.
- Do not modify the charger.
- The charger has been designed for a specific voltage. Always check the voltage is same as what is stated on the rating plate.
- Before using, check if the charger cord has any signs of damage.
- Do not abuse the charger cord.
- Do not wrap the cord around the charger when storing.
- Keep the charger cord away from hot surfaces and sharp edges.

Battery Safety

- This appliance includes Liion batteries. Do not expose it to high temperature or it may explode.
- Lithium-ion batteries perform best when they are kept at a moderate state of charge and are not allowed to discharge (Battery level reaches 0%). To increase the lifespan of the battery pack, do not allow the battery to reach 0% and recharge the battery regularly.
- The batteries are not replaceable. If you have a defective battery pack, please contact the Russell Taylors service team at support@russelltaylors.com.

Product Warranty

- This appliance has been designed for domestic dry vacuum cleaning only. Any evidence of commercial use will result in void of warranty.
- The vacuum cleaner is backed by a 2-year manufacturing warranty (The battery pack is covered by a 6 month warranty).

Introduction of components

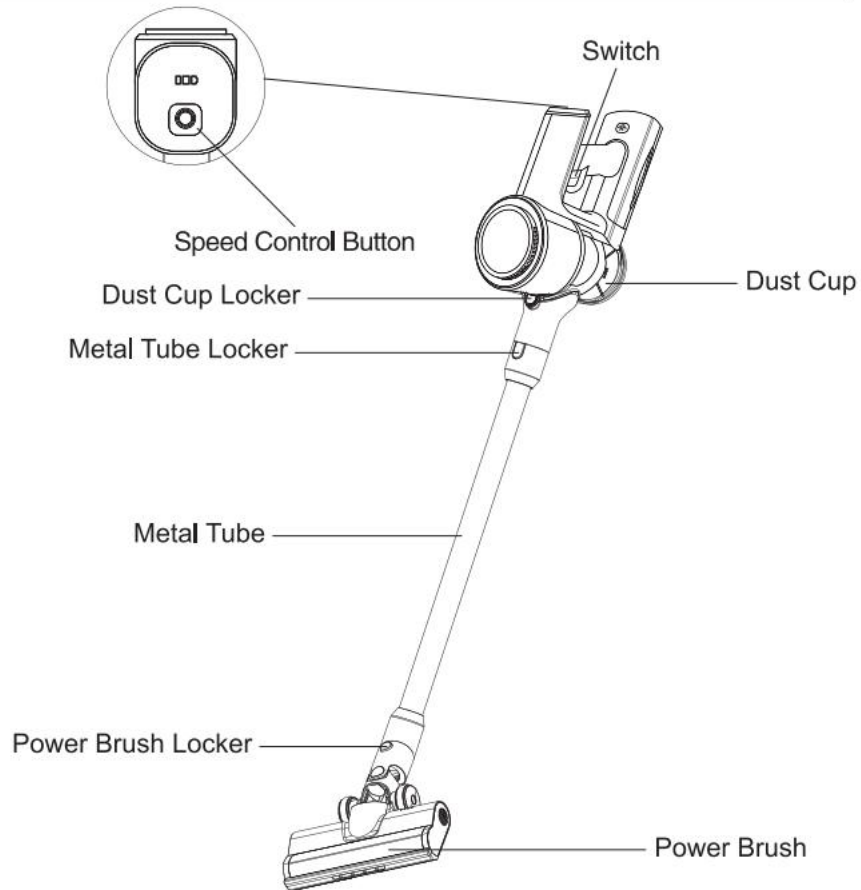

long crevice



2 in 1 crevice brush



Adapter

Product Installment

1. Using as a stick vacuum cleaner
 - a) Assemble the handle into the dust cup and make sure the battery bolt head is inserted into the dust cup slot as per below

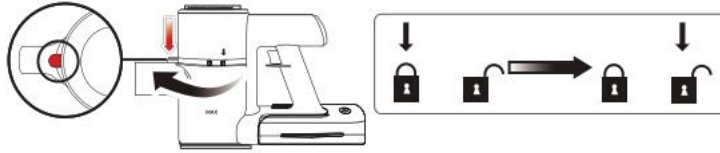

- b) Attach the metal tube to the body as below until you hear the click sound.

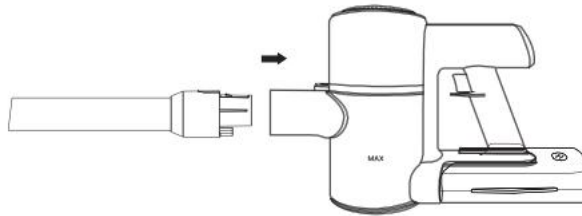

- c) Attach the brush to another head of the tube as shown.

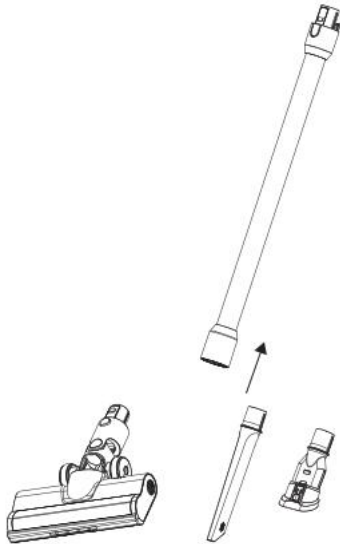

Product Operation

- When the last indicator light on the screen flashes, this indicates that the power is low and the battery needs to be charged immediately. Do not let the battery level reach 0% to protect the lifespan of the battery pack.
- Connect the charger to the power supply and the charging port.
- The battery pack enters charging mode when all the lights are flashing.
- The battery is full when the indicator lights are lit up permanently.
- You can also charge the battery pack when it is removed from the vacuum cleaner. The light on the battery pack will be red when charging and turns blue when it is done charging.

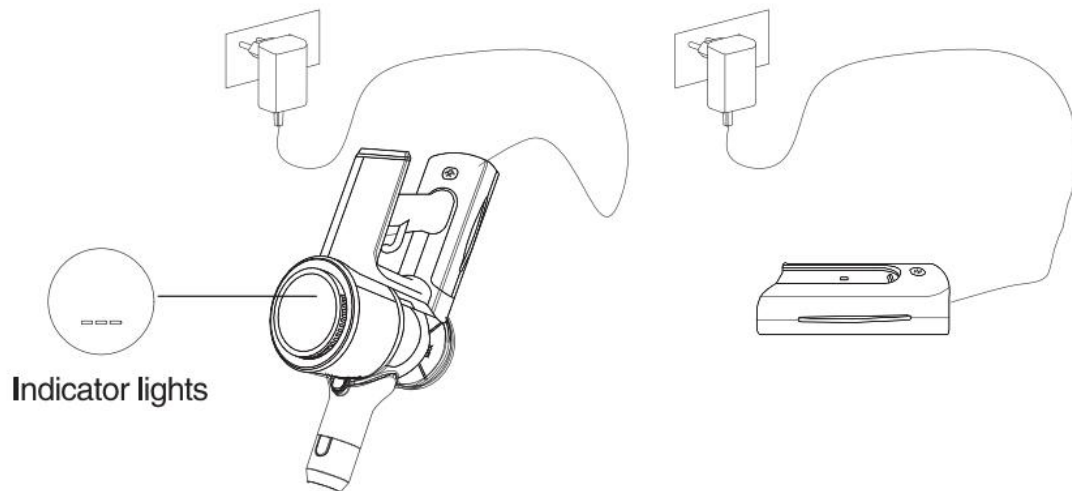

How to empty the dust cup

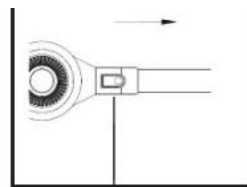

Metal tube locker
(1)

Press the metal tube locker then take out the metal tube

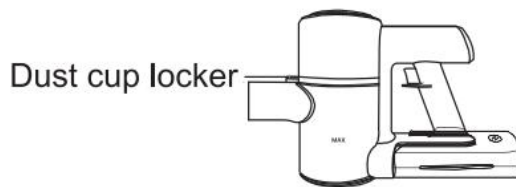

(2)

Unlock the dust cup locker

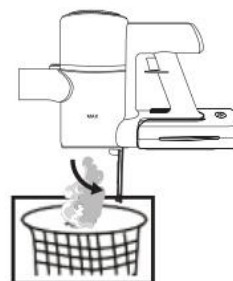

(3)

Empty the dust cup

Product Operation

How to maintain the filter

1. Press the release button to remove the handle part from dust cup

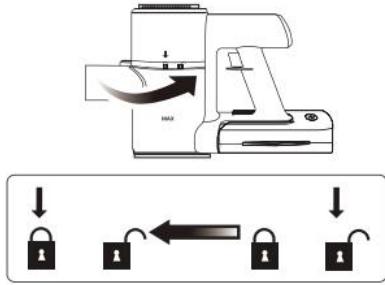

2. Take out the filter case, then take out the filter

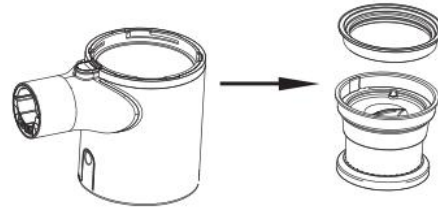

3. Wash the filter case and HEPA filter

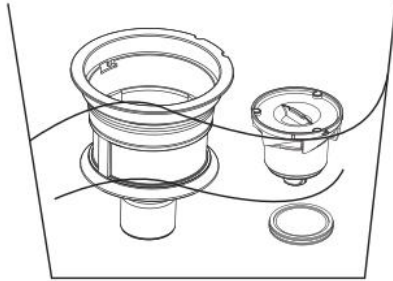

4. Drying filter

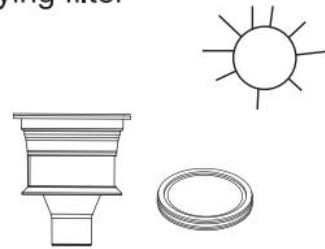

5. Assemble the filter to the case

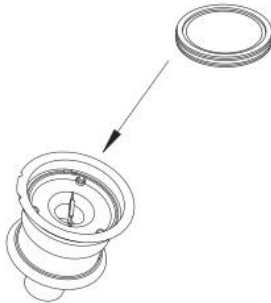

6. Put the filter case back to the dust cup

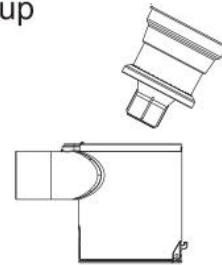

7. Assemble the dust cover into the dust cup

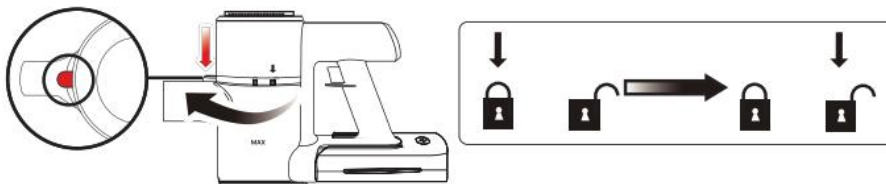

- For a better cleaning performance, we highly suggest cleaning the roller brush after every use and ensuring that the filter is cleaned. A blocked filter will result in reduction in suction power.

Troubleshooting

Suction is weak	<ol style="list-style-type: none">1. Empty the dust cup.2. Clean the filter3. Check if the dust cup is installed correctly4. Ensure the inside of the tube is not obstructed by dirt.
Not turning on	<ol style="list-style-type: none">1. Charge the battery2. Clean the brush3. If the product still is not working, contact our customer service department.
Roller brush stops spinning	<ol style="list-style-type: none">1. Check if the brush is blocked by hair (Mainly the bearing area).2. Check if the filter cup is installed correctly.
Battery is not charging	<ol style="list-style-type: none">1. Check if the charger is connected correctly.2. If there is no light during charging, contact our customer service department.

Russell Taylors