

Russell Taylors

www.russelltaylors.co.uk

Compact Sports Blender

E-WARRANTY



SCAN HERE

USER MANUAL



B1

This product is covered by a 2-year warranty against manufacturing defects. For all warranty claims, please email malaysia@russelltaylors.co.uk and include a copy of your invoice or order ID number as proof of purchase. You are entitled to one (1) warranty claim during the warranty period.

WARNING

1. This product is only suitable for domestic use. Please do not use it for other purposes.
2. Do not run this product without care.
3. This product is not intended for use by persons (including children) with physical, sensory, or mental impairment or lack of experience and knowledge in the use of it. Unless they are supervised or instructed by someone responsible for their safety in connection with the use of the appliance. Children should be taken good care of to ensure that they do not play with the product.
4. The input voltage of this product is 120 V 60 Hz, please check if it is in line with the local voltage before turning on the power supply. High or lower voltage may affect the performance of the product or damage electrical components, recommended the use of regulators to ensure the normal use of the product.
5. This product is limited to use with accessories (including connectors and parts sold independently by the company). Please do not use non-matching parts to avoid product performance or accidents.
6. Please check that the main body, cup body and other parts are in good condition before use. If damage is found, please stop using it and contact our customer service department in time. Do not disassemble and repair by yourself, lest influence product performance or occurrence accident.
7. If the power line is damaged, to avoid danger, it must be replaced by the manufacturer, a professional in its maintenance department or similar department.
8. Do not use wet hand plug, plug-in to avoid electric shock. When disconnecting the power supply, please hold the plug with your hand to pull out, do not pull the power cord; do not touch the sharp edge, sharp angle, and other things, lest damage leakage.
9. When using this product, please place it on a smooth table. Do not operate on tilted, unstable counter tops or on combustible items such as carpets, towels, plastics, paper, etc. Please stay away from the edge of the table to avoid dumping or accidents.
10. No-load (no food in cup) or overload (food quantity exceeding rated) is prohibited.
11. The operating speed of this product has been set to ideal state.
12. When installing the tool holder assembly, make sure to have a seal ring to avoid leakage, make sure the cup body and the tool seat

assembly are in place, do not install the tool holder on the main body separately.

13. Before turning on, make sure that the switch is off and that the cup and other parts are in place to avoid power loss or personal injury.

14. Turn off the power switch and disconnect the power before replacing the parts or touching the moving parts.

15. When the product works, it is strictly prohibited to move the product, lift the cup, or touch the blade, motor, and other movable parts to avoid causing personal injury or damage to the product.

16. Before assembling, disassemble, adjust, or clean any part of the product, please turn off the switch and disconnect the power, to avoid leakage or accidental start.

17. The continuous working time of product blending function cannot exceed 1 minute. If it doesn't reach the expected result, please turn off the switch and cool down for 2 minutes then restart blending work. After completing the blending work for 1 minute, stop for 2 minutes as a work cycle. After continuous working for 3 work cycles, must disconnect the power, and cool down for 15~20 minutes before restart working, which can extend product life.

18. If the blades are stuck, please turn off the switch and disconnect the power first to avoid injury or any damage to the blender.

19. When using the blending function, we suggest adding moderate amount of water or milk, for better blending function and longer product lifetime.

20. If the blender stops working when it runs, it may be caused by the overheat protection function. Please disconnect the power and cool down for 20~30 minutes.

21. After using the blender, please turn off the switch and disconnect the power first after the blades stop, and then take off the blend cup to avoid accident.

22. Please clean the parts contacted with food by water in time after using the blender, take out the blades. Please be careful when cleaning, please pay attention to sharp blades to avoid injure (suggest wear protective gloves when cleaning).

23. Please don't put any part of the product into dishwasher, microwave oven

24. Please don't place this product in an environment with high temperature, strong magnetic, flammable, or explosive gas (such as natural gas, biogas, etc.) to avoid accidents such as abnormal operation or fire.

25. Please turn off the switch and disconnect the power to avoid short circuit when no one is using.

26. When discarding this product or product packaging, please return it to the relevant qualified department for recycling. Please cut the power cord when discarding.

APPLIANCE DETAILS

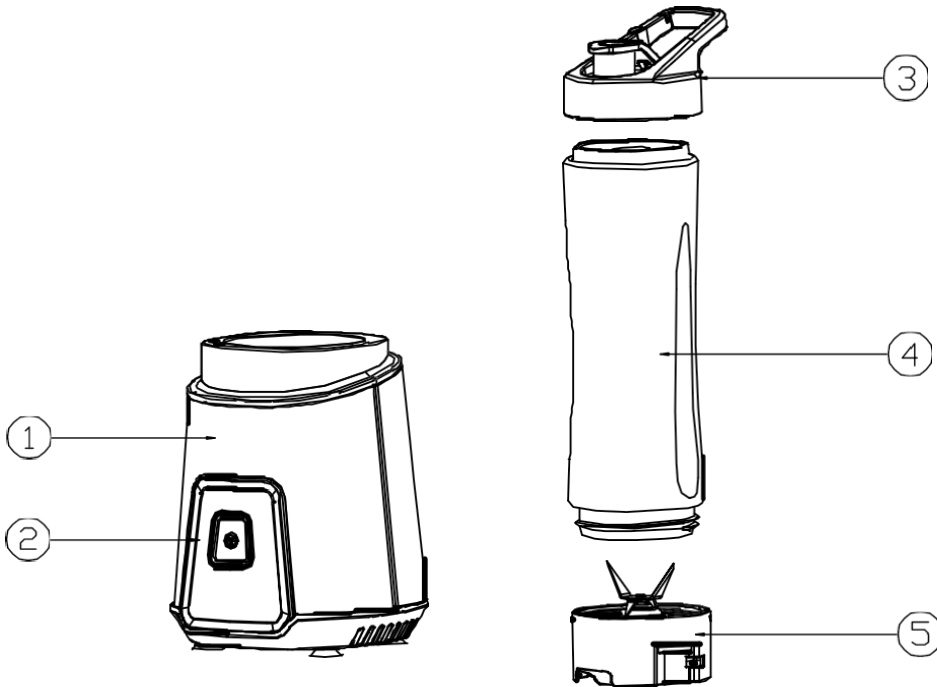

PARTS AVAILABLE

| No. | Part Name | Function Instruction |
|-----|--------------|--|
| 1 | Main Body | The main components of the main body, including the motor and other components, it is the power source of the blender. |
| 2 | Switch | Used to control the product on/off status, press, and hold to start, release to stop working. |
| 3 | Lid | Screw on the top of the blend bottle to form a seal. |
| 4 | Blend Bottle | Capacity 600ml, used for holding ingredients and combined with blade base to make juice, jam, milkshake, etc., combined with the lid to be used as a portable sports bottle. |
| 5 | Blade Base | It is used to pulverize ingredients and combine with a stirring cup to make juice, jam, milkshake, etc. |

CLEANING & MAINTENANCE

Please clean all parts touching food before the first use.

ATT: Please don't overload the blender as it's easy to damage the product. If processes much food in one go.

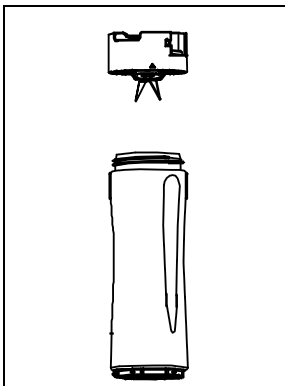

- Cutting the food into about 1.5x1.5 cm and put it in the bottle with water or milk.
- Put the blade base onto the blending cup, then tighten it clockwise.

Please don't put the hot food or water over 60°C. Pay attention that the whole volume cannot exceed the maximum scale-line position of the cup.

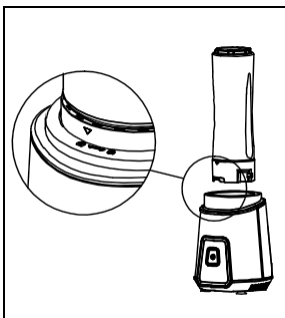

- Put the blending cup on the main body and be sure the upper concave parts fix well to the convex parts on the bottom of the cup, then tighten it clockwise.

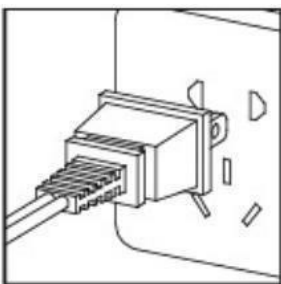

- Plug in the machine into 120 voltage with working time not over 60 seconds

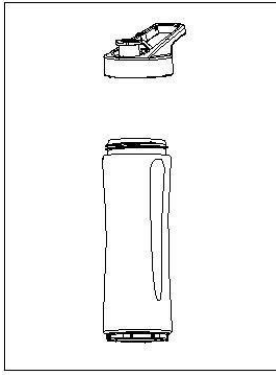

- Unplug the power after blending, Using drinking cap instead of blade base.

1. Please unplug the power and clean the cups.
2. Use a damp rag to wipe down the inside and outside of the main body. NEVER SUBMERGE THE MAIN BODY IN WATER OR PLACE IT IN DISHWASHER
3. Please pay attention when clean the blade.
4. QUICK CLEAN: Put some water into the cup and blend water for 5 to 10 seconds. Pouring out the water and wipe it dry.
5. If the machine is not going to be used for a long period of time, store in a dry and ventilated place

Russell Taylors

www.russelltaylors.co.uk