

Russell Taylors

E-WARRANTY



SCAN HERE

USER MANUAL

MICROWAVE

www.russelltaylors.co.uk



M2



IMPORTANT SAFEGUARDS

The following basic precautions should always be followed when using electrical appliance:

- 1.** Read all instructions before using.
- 2.** Make sure the voltage in your living area corresponds to the one shown on the rating label of the appliance and the wall socket is properly grounded.
- 3.** To reduce the risk of fire in the oven cavity:
 - a.** Do not overcook the food.
 - b.** Remove wire twist -ties from paper or plastic bags before placing bags in the microwave.
 - c.** Do not heat oil or fat for deep drying as the temperature of oil cannot be controlled.
 - d.** After use wipe the waveguide cover with a damp cloth, followed by dry cloth to remove any food splashes and grease. Built -up grease may overheat and begin to cause smoke or catch fire.
 - e.** If materials inside the oven should smoke or ignite, keep the microwave door closed, turn appliance off and disconnect the power supply.
 - f.** When heating food in plastic or paper containers, keep an eye on the microwave due to the possibility of fire.

- 4.** To reduce the risk of explosion and sudden boiling:
- a.** WARNING: Liquids and other foods must not be heated in sealed container since they are liable to explode. Baby bottles fitted with a screw cap or teat are considered to be sealed containers.
 - b.** Use the wide - mouthed container to heat liquid, and the heated liquid should not be removed out immediately. Several minutes should be waited before removing. In order to avoid possible hazards caused by delayed eruptive boiling of liquids.
 - c.** Potatoes, sausage and chestnut should be peeled or pierced before cooking. Eggs in their shell, whole hard -boiled eggs should not be heated in microwave ovens since they may explode, even after microwave heating has ended.
 - d.** The contents of feeding bottles and baby food jars are to be stirred or shaken and the temperature is to be checked before consumption, in order to avoid burns.
- 5.** If the supply cord is damaged, it must be replaced by the manufacturer or its service agent or a qualified technician in order to avoid a shock hazard.

- 6.** After cooking, the container is very hot. Use gloves to take out the food and avoid steam burns by directing steam away from the face and hands.
- 7.** To prevent the turntable from breaking:
 - a.** Let the turntable cool down before cleaning.
 - b.** Do not place hot foods or utensils on the cold turntable.
 - c.** Do not place frozen foods or utensils on the hot turntable.
- 8.** Make sure utensils do not touch the interior walls of the microwave during cooking.
- 9.** Only use utensils that are suitable for use in microwave ovens.
- 10.** Do not store food or any other things inside the oven.
- 11.** Do not operate the oven without any liquid or food inside the oven. This would damage the oven.
- 12.** When the appliance is operated, children should only use the oven under adult supervision due to the temperatures generated.
- 13.** Any accessories not recommended by the manufacturer may cause injuries to persons.
- 14.** Do not use outdoors.
- 15.** Save these instructions.

- 16. WARNING:** If the door or door seals are damaged or the oven is malfunctioned, the oven must not be operated until it has been repaired by the Russell Taylors service team;
- 17.** If smoke is emitted, switch off or unplug the appliance and keep the door closed in order to stifle any flames;
- 18.** Do not use harsh abrasive cleaners or sharp metal scrapers to clean the oven door glass since they can scratch the surface, which may result in shattering of the glass.
- 19.** The lamp of microwave oven is not intended for other purposes.
- 20.** The appliance is not intended to be operated by means of an external timer or separate remote-control system.
- 21.** This appliance is intended to be used in household and similar applications.
- 22.** The microwave oven is intended for heating food and beverages. Drying of food or clothing and heating of warming pads, slippers, sponges, damp cloth and similar may lead to risk of injury, ignition or fire.
- 23.** This appliance can be used by children aged from 8 years and above and persons with reduced physical, sensory or mental capabilities or lack of experience

and knowledge if they have been given supervision or instruction concerning use of the appliance in a safe way and understand the hazards involved. Children shall not play with the appliance. Cleaning and user maintenance shall not be made by children unless they are older than 8 and supervised. Keep the appliance and its cord out of reach of children less than 8 years.

- 24.** This appliance is not intended for use by persons (including children) with reduced physical, sensory or mental capabilities, or lack of experience and knowledge, unless they have been given supervision or instruction concerning use of the appliance by a person responsible for their safety.
- 25.** Children should be supervised to ensure that they do not play with the appliance.
- 26.** A steam cleaner is not to be used.
- 27.** The door or the outer surface may get hot when the appliance is operating.
- 28.** WARNING: Accessible parts may become hot during use.
- 29.** During use the appliance becomes hot. Care should be taken to avoid touching heating elements inside the oven.
- 30.** The surfaces are liable to get hot during use.

INSTALLATION

- 1.** Take out all the packing. If there is a safe film over the oven, tear it off before use. Check carefully for any damage. If any, immediately notify the dealer or send it to the manufacturer's service center.
- 2.** Microwave ovens must be placed under dry and non-corrosiveness environments, kept away from heat and humidity, such as a gas burner or a water tank.
- 3.** To ensure sufficient ventilation, the distance of the back of microwave to the wall should be at least 10 cm, the side to the wall should be at least 5 cm, the free distance above the top surface at least 20 cm. the distance of the microwave to the ground should be at least 85 cm.
- 4.** The position of the oven shall be such that it is far from the TV, Radio or antenna as picture disturbance. The distance should be more than 5m.
- 5.** The appliance must be positioned so that the plug is accessible, and must ensure a good grounding in case of leakage. A ground loop can be formed to avoid electric shock.
- 6.** The microwave oven must be operated with the door closed.

7. The microwave oven must not be placed in a cabinet. The microwave oven is intended to be used freestanding.

8. As there is manufacturing residue or oil remained on the oven cavity or heat element, it usually would emit the odor, even a slight smoke. It is normal case and would not occur after several times of use, keep the door or window open to ensure good ventilation. It is strongly recommended to place a cup of water in the turntable, setting at high power and operate for several times before the first use.

CLEANING

MICROWAVE OVEN CARE



CAUTION

The oven should be cleaned regularly and any food deposits removed.



WARNING

- 1.** Remove the power cord from the wall outlet before cleaning. Don't immerse the appliance in water or other fluids when cleaning.
- 2.** Failure to maintain the oven in a clean condition could lead to deterioration of the surface that could adversely affect the lifespan of the appliance and

possibly result in a hazardous situation

3. Never use hard detergent, gasoline, abrasive powder or metal brush to clean any part of the appliance

4. Do not remove the waveguide cover

5. When the microwave oven has been used for a long time, there may be some odors in the oven.

Following 3 methods can get rid of them:

a. Place several lemon slices in a cup, then heat with high Micro Power for 2–3 min.

b. Place a cup of red tea in the oven, then heat with high micro power.

c. Put some orange peels into oven, and then heat them with high Micro Power for 1 minute.

6. WARNING: Only allow children to use the oven without supervision when adequate instructions have been given so that the child is able to use the oven in a safe way and understands the hazards of improper use.

PRODUCT INSTRUCTION

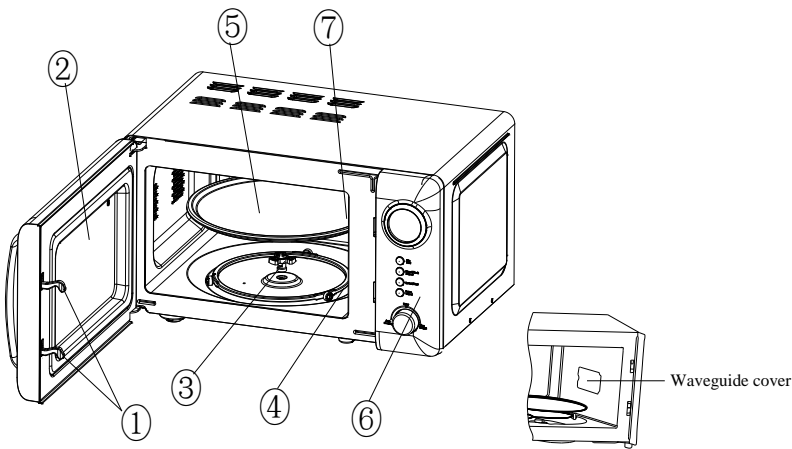

1) **Door lock**

Microwave oven door must be properly closed in order for it to operate

2) **Viewing window**

Allows user to see the cooking status

3) **Rotating axis**

The glass turntable sits on the axis; the motor underneath it drives the turntable to rotate

4) **Rotating ring**

The glass turntable sits on its wheels; it supports the turntable and helps it to balance when rotating

5) **Turntable**

The food sits on the turntable, its rotation during operation helps to cook food evenly



CAUTION

- Place the rotating ring first
- Fit the turntable onto the rotating axis and make sure that it is geared in properly

6) **Control panel**

See below in details (the control panel is subject to change without prior notice)

7) **Waveguide cover**

It is inside the microwave oven, next to the wall of control panel.



WARNING

Never remove the waveguide cover

OPERATION OF CONTROL PANEL

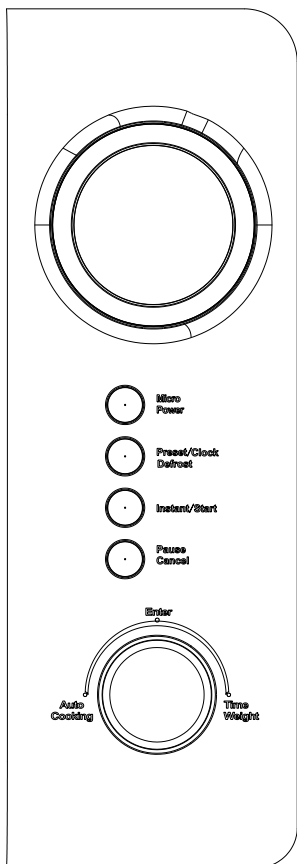

1. BEFORE COOKING

The LED flashes 3 times when plugged in to the power supply. Then it flashes “:”, prompting you to input the cooking menu and time.

2. AUTO COOKING/ TIME WEIGHT KNOB

You can increase or decrease cooking time, weight or choose the auto cooking menu during operation by

turning the **Auto cooking /Time Weight** knob.

3. PAUSE/CANCEL

At the initial or input stage: press once to cancel input programs and resume back to the initial stage.

During cooking: press once to stop oven operation, press twice to cancel cooking programs.

4. AUTO REMINDER

When your preset cooking procedure have finished, the LED display will show **End** and three beeps sound will be heard to prompt you to take out food. If you do not press **Pause/Cancel** button once or open the door, the beep will be sounded at an interval of 3 minutes.

5. CLOCK SETTING

Preset /Clock Defrost button makes it available for you to input current or preset time when “:” flashes onto LED display after the oven is plugged in, or you can skip it over to continue if unnecessary.

Example: to set 12:30		
	Steps	Display
1	After power-up, the LED flashes	:
2	Hold Preset /Clock Defrost button for three seconds	0:00
3	Turn Auto Cooking/Time Weight knob to set exact hours.	12:00
4	Press Preset /Clock. Defrost button once again.	12:00
5	Turn Auto Cooking/Time. Weight knob to set exact minutes.	12:30
6	Press Preset /Clock. Defrost button once again or wait for 5 seconds, and the numbers will count down	

6. MICROWAVE COOKING

This function is used for cooking and heating food. Press **Micro Power** button and the LED will cycle to show 100P — 80P — 60P — 40P — 20P.

100P	100% microwave power. Applicable for quick and thorough cooking
80P	80% microwave power. Applicable for medium express cooking
60P	60% microwave power. Applicable for steaming food
40P	40% microwave power. Applicable for defrosting food

20P	20% microwave power. Applicable for keeping warm
-----	--

CAUTION

- The max time which can be set is 60 minutes.
- Never operate the oven empty.
- If you turn the food during operation, press the **Instant/Start** button once and the preset cooking procedure will continue.
- If you intend to remove the food before the preset time, you must press **Pause/Cancel** button once to clear the preset procedure.
- At the maximum microwave power, the oven will automatically lower the power after a certain time of cooking to lengthen the service life.

Example: To cook at P80 for 10 minutes.		
	Steps	Display
1	After power-up, the LED flashes	:
2	Select the desired microwave power by pressing the Micro Power button consecutively	80P
3	Set cooking time by turning Auto Cooking/Time Weight knob	10:00
4	Press Instant /Start button and the LED will count down to show the running time.	

7. DEFROST

This function is used to defrost food; Press the **Preset/Clock Defrost** button and the LED display will cycle to show d.1-d.2-d.3.

d.1	For defrosting meat, the weight ranges from 0.1 to 2.0 kg.
d.2	For defrosting poultry, the weight ranges from 0.2 to 3.0kg.
d.3	For defrosting seafood, the weight ranges from 0.1 to 0.9kg.

CAUTION

- It is necessary to turn over the food during operation to obtain uniform effect.
- Usually defrosting will need longer time than that of cooking the food.
- If the food can be cut with a knife, the defrosting process can be considered completed.
- Microwave penetrates around 4cm into most food.
- Defrosted food should be consumed as soon as possible, it is not advised to put back to fridge and freeze again.

Example: To defrost 0.4kg poultry		
	Steps	Display
1	After power-up, the LED flashes	:
2	Press Preset /Clock Defrost button to set the defrost cycle	d.2

3	Turn Auto cooking/Time Weight knob to set the defrost weight	0.4
4	Start cooking by pressing Instant/Start button	5:16
5	Half way during defrosting, a beep sound will be heard to prompt you turn over the food. Open the door and turn over the food. Then close the door. Press Instant/Start button again to continue defrosting	

8. CHILD LOCK FUNCTION

Use this feature to lock the control panel when you are cleaning or so that children can not use the oven unsupervised. All the buttons are rendered inoperable in this mode.

Set child lock: Hold **Pause/Cancel** button about 3 seconds.

Cancel child lock: Hold **Pause/Cancel** button about 3 seconds.

9. AUTO COOKING

The oven has default cooking menu for simple operation. When the LED flashes “:”, turn the knob and LED will cycle to show A-01, A-02 A-12. After selecting the auto cooking menu, press the **Enter** button to set the cooking weight.

Choose the appropriate menu according to the food

type and weight and strictly observe the directions in below table, otherwise the cooking effect will be affected.

Display	Kind	Weight
A-01	Popcorn	All together there are two choices (3.0Oz and 3.5Oz)
A-02	Potato	All together there are two choices (0.45Kg and 0.65Kg)
A-03	Vegetable	All together there are five choices (0.1 0.2-----0.5Kg)
A-04	Meat	All together there are six choices (0.2 0.3-----0.7Kg)
A-05	Fish	All together there are six choices (0.2 0.3-----0.7Kg)
A-06	Chicken	All together there are six choices (0.2 0.3-----0.7Kg)
A-07	Reheat	All together there are five choices (0.2 0.4-----1.0Kg)
A-08	Beverage	All together there are two choices (250MI and 500MI)
A-09	Rice	All together there are five choices (0.1 0.2-----0.5Kg)
A-10	Pasta	All together there are five choices (0.1 0.2-----0.5Kg)

A-11	Bread	All together there are five choices (0.1 0.2-----0.5Kg)
A-12	Pizza	All together there are two choices (1 share and 2 share)

CAUTION

- The temperature of food before cooking would be 20–25°C. Higher or lower temperature of the food before cooking would require increase or decrease of cooking time.

10. DELAYED START

If you do not want the microwave to start immediately, you can preset the cooking menu and time and the preset menu will be automatically started at your set time. The setting will consist of 2 steps:

- Setting the current clock;
- Setting the cooking menu and time.

Example: Now it is 12:30 Clock, if you hope that the microwave oven will automatically start cooking with 100P microwave power for 9 minutes and 30 seconds at 14:20

	Steps	Display
1	After power-up, the LED flashes	:
1.1	Hold Preset/Clock Defrost button for three seconds	0:00

1.2	Set hours by turning Auto Cooking/Time Weight knob	12:00
1.3	Press Preset/Clock Defrost button again to confirm hours	12:00
1.4	Set minutes by turning Auto Cooking/Time Weight knob	12:30
1.5	Press Preset/Clock Defrost button once or waiting for 5 seconds, and the numbers will stop blinking.	12:30
2	Set the cooking menu and time	
2.1	Select cooking power by pressing Micro Power button	100P
2.2	Turn Auto Cooking/Time Weight knob to set cooking time	9:30
2.3	Press and hold Preset/Clock Defrost button for 3 seconds to return to the current clock.	
3	Set the time you expect to start. Repeat the steps of 1.2, 1.3, 1.4	
4	Press Preset/Clock Defrost button to confirm the delayed menu. Now the program has been activated. And the menu will be started at 14:20.	
5	You may check the preset starting time by pressing Preset/Clock Defrost button.	

CAUTION

If you want to start the set program immediately without waiting, just press **Instant/Start** button; if “Automatic starting” need to be cancelled, press **Pause/Cancel** button.

11. MULTI-SEQUENCE COOKING

To obtain the best cooking result, some recipes call for different cooking modes and time. You may program your personalized menu as follow:

Example: You want to cook food with 100P microwave for 3 minutes then 20P for 9 minutes. This is a 2 sequence setting.		
	Steps	Display
1	100P microwave for 3min.	
1.1	Press Micro Power button to select power level.	100P
1.2	Turn Auto Cooking/Time Weight knob to set cooking time.	3:00
2	20P for 9min.	
2.1	Press Micro Power button to select power level.	20P
2.2	Turn Auto Cooking/Time Weight knob to set cooking time.	9:00
3	Start cooking by pressing Instant/Start button.	

UTENSILS GUIDELINE

It is strongly recommended to use the containers which are suitable and safe for microwave cooking. Generally speaking, the containers which are made of heat-resistant ceramic, glass or plastic are suitable for microwave cooking. Never use metal containers for microwave cooking and combination cooking as spark is likely to occur. You can take the reference of below table.

Material of container	Safe for Microwave	Notes
Heat-resistant ceramic	Yes	Never use the ceramics which are decorated with metal rim or glazed
Heat-resistant plastic	Yes	Can not be used for long time microwave cooking
Heat-resistant glass	Yes	
Plastic film	Yes	It should not be used when cooking meat or chops as the over-temperature may do damage to the film
Grill rack	No	
Metal container	No	It should not be used in microwave oven. Microwave cannot penetrate through metal.

lacquer	No	Poor heat-resistant. Can not be used for High-temperature cooking
Bamboo wood and paper	No	Poor heat-resistant. Can not be used for High-temperature cooking