

Russell Taylors

SLOW JUICER

www.russelltaylors.co.uk

E-WARRANTY



SCAN HERE



SJ1

For warranty claims, please submit an email to malaysia@russelltaylors.com together with your order number or a copy of your invoice. This product is backed by a 2-year warranty against manufacturing defects.

Important Safeguards

1. Make sure the electricity supply used is suitable for the product.
2. This product is only for household use. Any evidence of commercial use will result in void of warranty.
3. Use the product as only described in this manual.
4. To prevent from electrical shock, do not submerge the unit, cord and plug into water.
5. This product is not to be used by children and close supervision is required when the unit is used near them.
6. Ensure that the product is unplugged when not in use, assembling or disassembling, and before cleaning.
7. The continuous operation time of this product is 20 minutes.
8. Do not overload the machine.
9. Do not use your finger, spoon or chopstick to push fruits and vegetables into the chute of the machine. Only use the pusher provided to do so.
10. Do not open the unit while it is operating.
11. Do not place the unit near any explosives, heated ovens or hot surfaces.
12. Operate the product only on a flat surface.
13. Do not let the cords hang over the edge of the table.
14. Hold the plug to disconnect it from the power socket.
15. This product is not intended to be used by persons with weak physical condition, slow reaction, mental disabilities or lack of experience unless they are under supervision or instruction by the person who is responsible for their safety.

ATTENTION

The juicer is not suitable for juicing very hard or fibrous and starchy fruits or vegetables such as Sugar Cane or Ginger. There are some fruits that contain too much starch to juice, such as avocado, banana, figs, mango, papaya, dragon fruit & strawberry. They will clog up with stainless steel sieve.

Diagram of Product Components

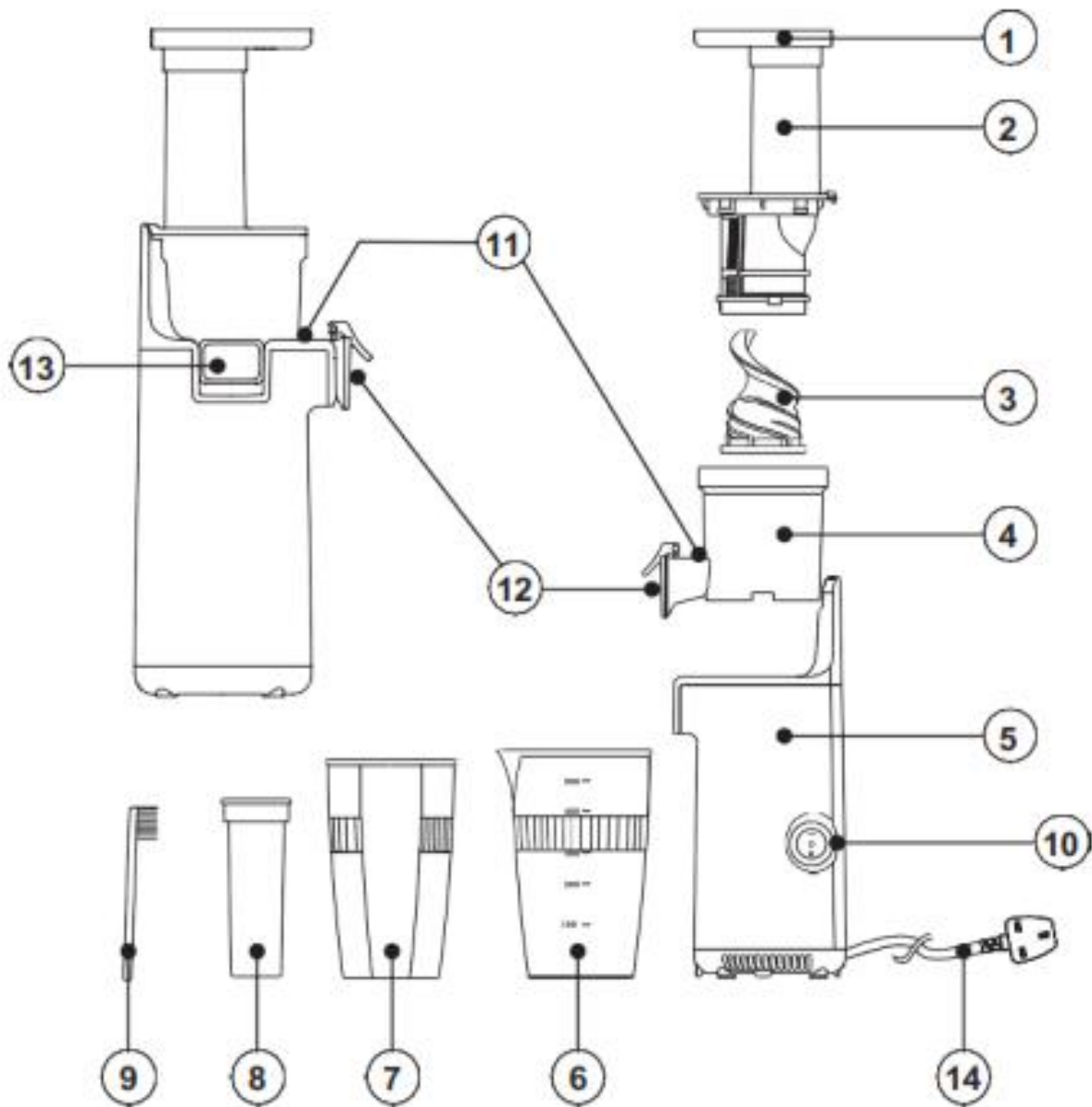

1	Food Tray	8	Pusher
2	Chute & Strainer Assembly	9	Cleaning Brush
3	Squeezing Auger	10	On / Off / Reverse Switch
4	Juicing Bowl	11	Juice Spout
5	Power Base	12	Drip-stop cover
6	Juice Container	13	Pulp Spout
7	Pulp Container	14	Power Cord

First Use

1. Remove all packaging materials, plastic bags and labels.
2. Make sure the electricity supply is 220-240V~50-60Hz.
3. Ensure that all components that come into contact with fruits or vegetables are washed with soapy water then rinsed and dried.
4. Assemble the parts as per the instructions in the assembling method section.
5. Connect the power cord to the power source.

Assembling Method

1. Make sure the unit is not switched on prior to assembling the machine.
2. Position the squeezing bowl on the power base and align the position of the spouts and the axle. (Fig 1)
3. Push the squeezing auger firmly into the centre of the bowl, making sure that it touches the bottom. Failing to do so will not allow the cover to be closed. (Fig 2)
4. Position the chute on the bowl to align the ▲ to the 🔒 twist it clockwise until the safety lock clicks. Make sure that the arrow ▲ is aligned with the lock 🔒 graphic on the bowl. (Fig 3)
5. Place the juice container and the pulp container under the relevant spouts. (Fig 4)

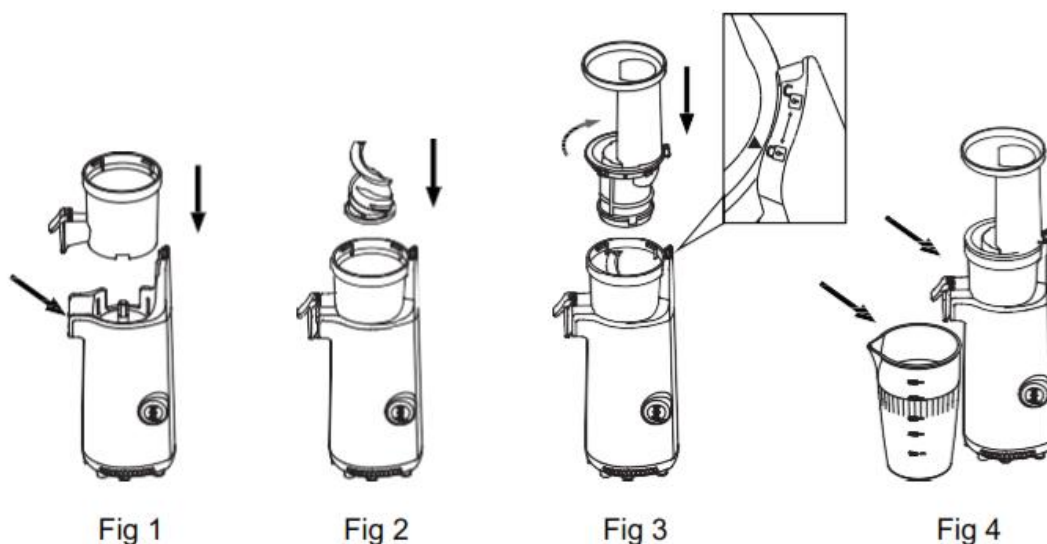

Operating Instructions

1. Connect the unit to your power source.
2. Check and make sure all the parts are well assembled in the correct position based on the assembling method on page 3.
3. Make sure the machine is at the off "O" position.
4. Make sure the juice and pulp containers are in position.
5. Ensure the juice spout cover is closed.
6. Prepare the fruits and vegetables and cut them into pieces of a max of 5cm x 2cm strips or 3cm x 3cm cubes.
7. Put the fruit strips/cubes into the chute.
8. Switch on the product and set it to "-" to start the juicing process.
9. Push the food down with the pusher provided only. Do not use a fork, chopstick or your finger.
10. In case food is stuck in the bowl, switch to "R" to use the reverse function instantly.

Juice Spout Cover

1. During the juicing process, keep the drop stop cover closed before the juice is full in the juicing bowl.
2. This is to stop dripping at the end of juicing & mix the juice with your different fruits and vegetables.

Usage Tips

1. Remove the hard pits or seeds prior to juicing to prevent damage to the squeezing auger.
2. If mixed fruits are being made, begin with the harder fruit and then squeeze the soft fruits.
3. Let the juice run for 30 seconds after the last ingredient was fed.

Disassembling Method

- To disassemble the unit, switch off the juicer and disconnect it from the power source.
 - Follow the instructions below
1. Remove the juice and pulp containers. (Fig 6)

2. Remove the chute. Turn the chute anti-clockwise until the ▲ aligns with the 🔒 sign. (Fig 7)
3. Remove the auger by pulling it out upward. If it is very hard, gently twist and pull. (Fig 8)
4. Remove the bowl by lifting it upward vertically. (Fig 9)

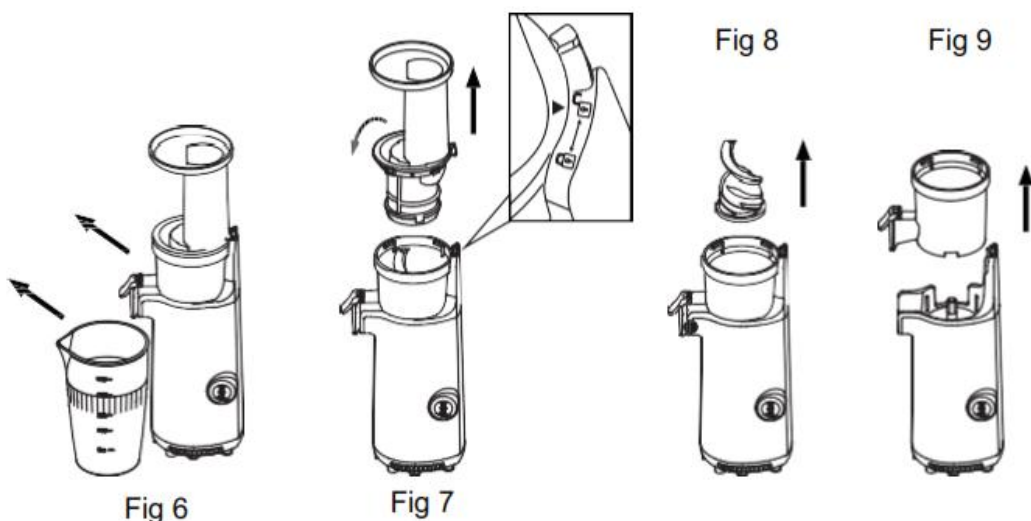

Cleaning & Maintenance

Wash the juicing parts after each use, or the pulp will get stuck in the juicing bowl and auger which will then after the disassembly, cleaning and juicing performance.

1. Switch off and unplug the juicer.
2. Wash the disassembled parts (Fig 10) with water. If the meshes are clogged with pulp, use the cleaning brush provided to remove them.
 - a. Do not use an iron wire brush

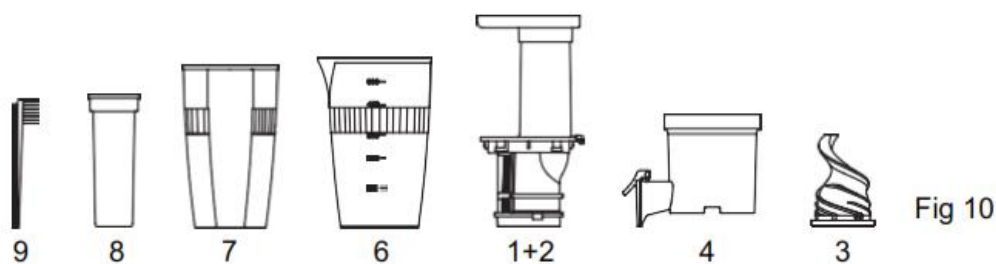

3. In case there is any residue in the mouth of the pulp spout, pull out the silicone valve as shown in Fig 11 below and clean it under running water.

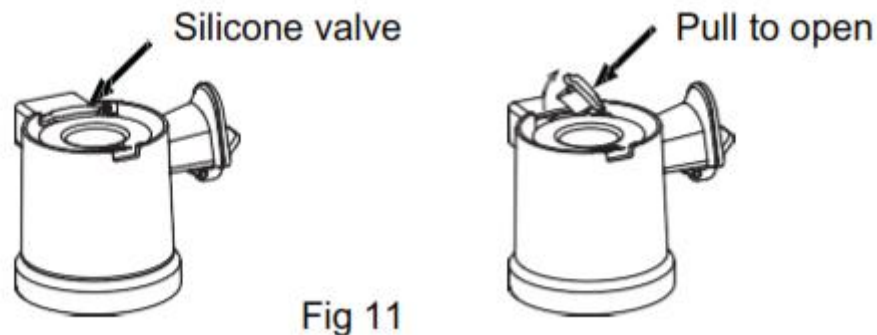

4. To clean the seal ring in the centre of the squeezing bowl, follow the steps below
 - a. Turn the squeezing bowl upside down for easier handling. Push the seal ring out with your thumb (Fig 12a) and clean it with water.
 - b. After cleaning, put it back to the centre hole. The small, ribbed surface should face upward (Fig 12b). Make sure the groove of the seal ring fits well into the squeezing bowl.
 - c. The big flat size of the seal ring will be inside while the small and ribbed side is outside the squeezing bowl. (Fig 12c)

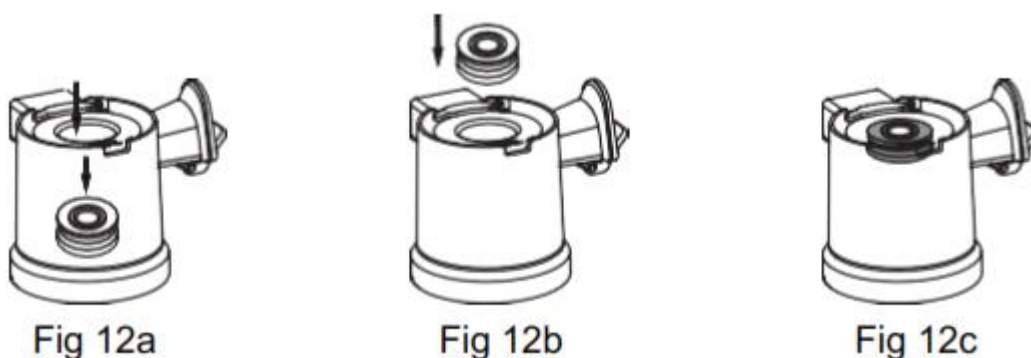

5. Do not put the power base into water for cleaning. Wipe it with a damp cloth.
6. After cleaning, dry all the parts thoroughly and store them in a dry and cool place.

Troubleshooting

Trouble	Cause	Solutions
The juicer suddenly stopped running.	Too many ingredients inside the juicer	Switch to "R" position to make the ingredients return upwards. If the machine still stops running, clean the machine before using again.
	Hard fruits or vegetables not cut into small pieces	Hard fruits and vegetables (such as carrots) must be cut into strips or small cubes before putting into the chute.
Low juice yield or juice flows out of the main housing.	Bowl and silicone valve are not installed properly.	Re-install the bowl silicone valve by referring to the installation method.
Abnormal Noise.	Parts causing abnormal sounds during squeezing.	The sound is caused by the extrusion of fruits which is a normal phenomenon.
Chute & strainer assembly cannot be opened.	There is too much pulp inside the bowl	Press the "R" setting to eject the pulp backward.
	There is hard food stuck inside	Press the "R" setting to eject the food backward.
	The pulp is stuck	Pour water into the chute to soften the pulp overnight.
The container & accessories are dyed after use.	Dyed parts are due to natural colour of fruits and vegetables.	This is a natural occurrence and cannot be avoided.