

ZETA SERIES

INSTRUCTION MANUAL

E-WARRANTY



SCAN HERE

Russell Taylors



WARRANTY

- This product is backed by a 2-year warranty against manufacturing defects.
- Wear and tear of the filter is not covered by the 2-year warranty. If a replacement is required, please contact our customer service team to order a replacement.
- This product is only for household use. Any evidence of commercial use will result in void of warranty.
- You may register your warranty through our website (www.russelltaylors.co.uk).

BEFORE FIRST USE

- To avoid electrical shock or fire, do not allow water or any flammable detergent to enter the product.
- Do not spray insecticide, perfume or other flammable sprays around the product.
- Before connecting to the power supply, check if the voltage of the product is consistent with the local power supply voltage.
- Ensure that the product is used on a stable and horizontal surface.
- Leave at least 30cm of space on the back and sides of the product, and at least 50cm of space above the product when using.
- Ensure both the filter and its cover are properly installed before using.
- Do not insert your fingers or other objects into the outlet/inlet to prevent damage.

PRODUCT DIAGRAM

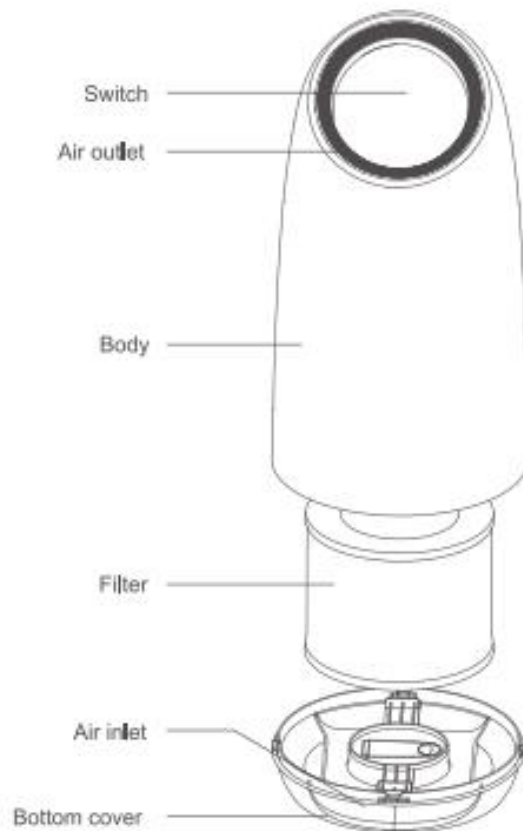

BUTTON FUNCTIONS

- When the product is connected to power, the machine will ring and will automatically enter its auto mode. The model will be displayed according to the PM2.5 detection value.
- **Power on button**  : In standby mode, touch the power button and the machine will ring and enter into auto mode. The mode will be displayed based on the PM2.5 detective value.
- **Power off button:** Using the same button as the power on button, Touch the button to turn off the air purifier.
- **UV function:** After turning on the machine, the UV will automatically turn on for 2 hours and turn off by itself on a fixed cycle. This cycle cannot be turned off.

Wi-Fi Function

Download & Login

1. Using your smart phone, download the “Smart Life” App from Google Playstore or Apple Appstore.
2. Open the app and register an account using your phone number or e-mail address and login.

Adding Device

1. Connect your smart phone to your wireless network and turn on the Bluetooth on your phone (Select a 2.4Ghz Wifi Network)
2. Open the “Smart Life” app.
3. Enter the homepage of the “Smart Life” app and then click the “+” icon to add a device. The app will display two options, a manual addition and automatic discovery.
4. **Automatic Discovery:** When selected,

Filter Replacing

The filter replacement instructions will appear on the app when the filter needs to be replaced. Please use the original filter sold by the manufacturer. Do not use any other filter as they will not fit.

1. Before replacing the filter, make sure the machine is turned off. Pull the plug from the power socket and remove the rear cover and take out the filter.
2. Tear the protective film of the new filter and push it into the machine and close the rear cover.
3. After replacing the filter, plug in the power supply, turn on the machine and press the power off button for 5 seconds to clear the filter alarm and recalculate the filter life span.

Note:

- Clean the dust on the filter regularly. The filter cannot be washed or reused.

- Before replacing the filter, turn off the machine and pull the plug off the power socket.
- Do not clean the filter with a vacuum cleaner.
- Put the filter in direct sunlight regularly to sterilize it.

Filter Installation

1. Remove the packing material of the filter before using. Make sure the air purifier is turned off before installing the filter.
2. Open the bottom cover by turning it in the direction of “open”.
3. Remove the filter and adapter.
4. Put the new filter into the air purifier.
5. Install the bottom cover to the air purifier, hold the handle and rotate to the “close” direction and tighten it.

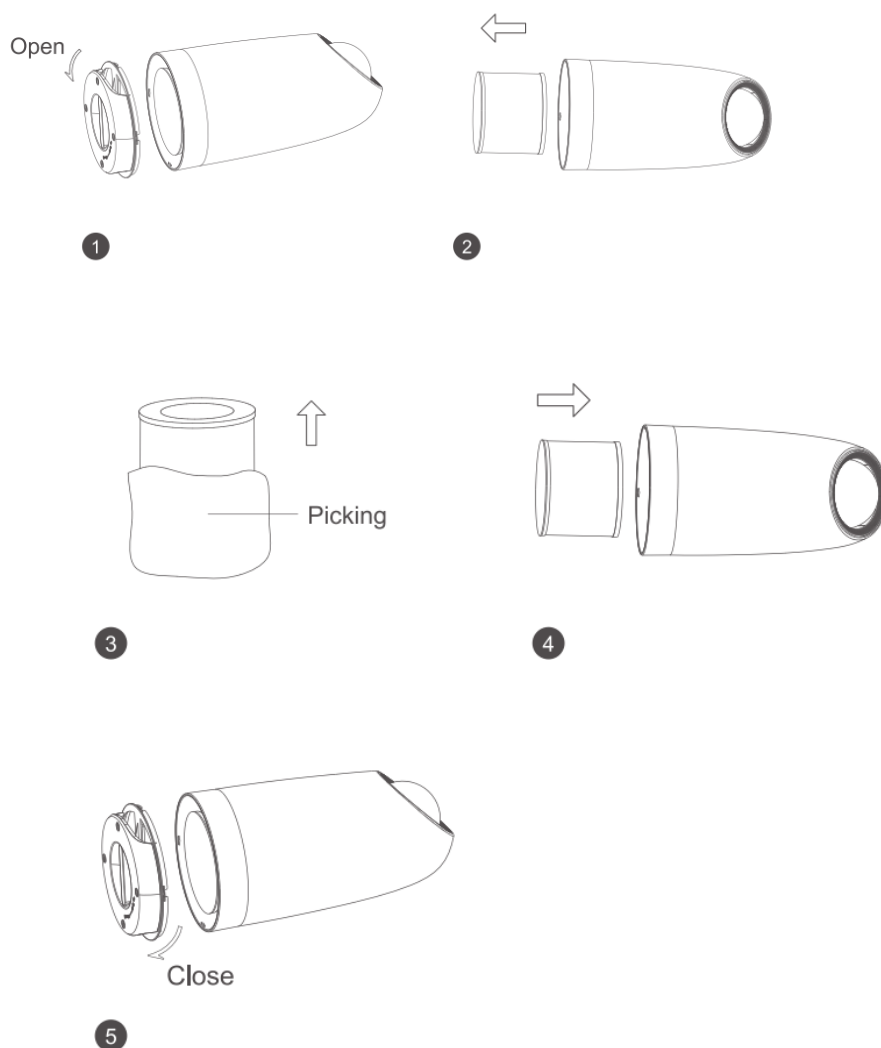

Maintenance

1. Ensure that the machine is unplugged before maintenance.
2. Do not immerse the product in any liquid.
3. Do not use any abrasive, corrosive or flammable cleaners.
4. Do not wash the filter.
5. Do not use a vacuum cleaner to clean the filter.

Cleaning

1. Ensure that the machine is turned off and unplugged.
2. Take out the filter and clean the dust absorbed on the outer surface of the filter.
3. Use a soft cloth with a neutral cleanser to clean away any dust or debris from the surface of the machine and air inlet/outlet.
4. After the machine completely dries, put it in a cool and well-ventilated space.

Storage

1. Turn off the machine and unplug the power supply and bundle the power cord.
2. Take out the filter and clean the dust absorbed on the outer surface of the filter.
3. Clean the air inlet/outlet, wipe the body with a neutral detergent and a soft cloth.
4. After the machine is completely dried, put on a dust cover or bag and place it in a well-ventilated place not exposed to direct sunlight.
5. If you do not use it for a long time, turn on the machine for a few minutes from time to time to ensure peak performance.

Troubleshooting

PROBLEM	RESOLUTION
The product is not working	<ul style="list-style-type: none">• Is it plugged into a power socket?• Is the switch leaking or fuse cut off?• Is the filter replacing indicator flashing?
Poor performance	<ul style="list-style-type: none">• Is there any dust in the surface of the pre-filter?• Is there any obstacle blocking the air inlet/outlet?
Very Noisy	<ul style="list-style-type: none">• Is there anything stuck on the fan in the air outlet?<ul style="list-style-type: none">• Is the machine tilted?
Bad odour from the air purifier	<ul style="list-style-type: none">• Normal phenomenon that the machine emits a plastic smell for the first use.• The machine will emit a nasty smell if the filter is dusty, in this case, please clean or replace the filter.• If there is a burning smell coming from the machine, please unplug the power socket and contact our customer service.