

Russell Taylors

E-WARRANTY



SCAN HERE

www.russelltaylors.co.uk

USER MANUAL

VACUUM CLEANER VC22



Safety Instructions

Warning: Basic safety precautions should always be observed when using an electrical appliance, including the following to reduce the risk of fire, electrical shock or injury.

- Store the vacuum in a dry place out of reach of children.
- The appliance is not intended for use by persons (including children) with reduced physical, sensory or mental capabilities, or lack of experience and knowledge, unless they have been given supervision or instruction concerning the use of this appliance by a person responsible to their safety.
- Children must be supervised to ensure that they do not play with the appliance.
- Use only the attachments provided in the packaging. Any misuse or use of any accessory or attachment that was not provided by Russell Taylors may present a risk of personal injury.
- Keep the appliance and accessories away from hot surfaces.
- Do not block the appliance openings or hinder air flow. Keep the openings free of any objects including dust, lint, clothing and fingers.

Electrical Safety

- Only use the battery and charger supplied in the original packaging, The appliance is only to be used with the power supply unit provided in the packaging.
- Do not modify the charger.
- The charger has been designed for a specific voltage. Always check the voltage is same as what is stated on the rating plate.
- Before using, check if the charger cord has any signs of damage.
- Do not abuse the charger cord.

- Do not wrap the cord around the charger when storing.
- Keep the charger cord away from hot surfaces and sharp edges.

Battery Safety

- This appliance includes Li-ion batteries. Do not expose it to high temperature or it may explode.
- Lithium-ion batteries perform best when they are kept at a moderate state of charge and are not allowed to discharge (Battery level reaches 0%). To increase the lifespan of the battery pack, do not allow the battery to reach 0% and recharge the battery regularly.
- The batteries are not replaceable. If you have a defective battery pack, please contact the Russell Taylors service team at support@russelltaylors.com.

Product Warranty

- This appliance has been designed for domestic dry vacuum cleaning only. Any evidence of commercial use will result in void of warranty.
- The vacuum cleaner is backed by a 2-year manufacturing warranty (The battery pack is covered by a 6-month warranty).

Parts List

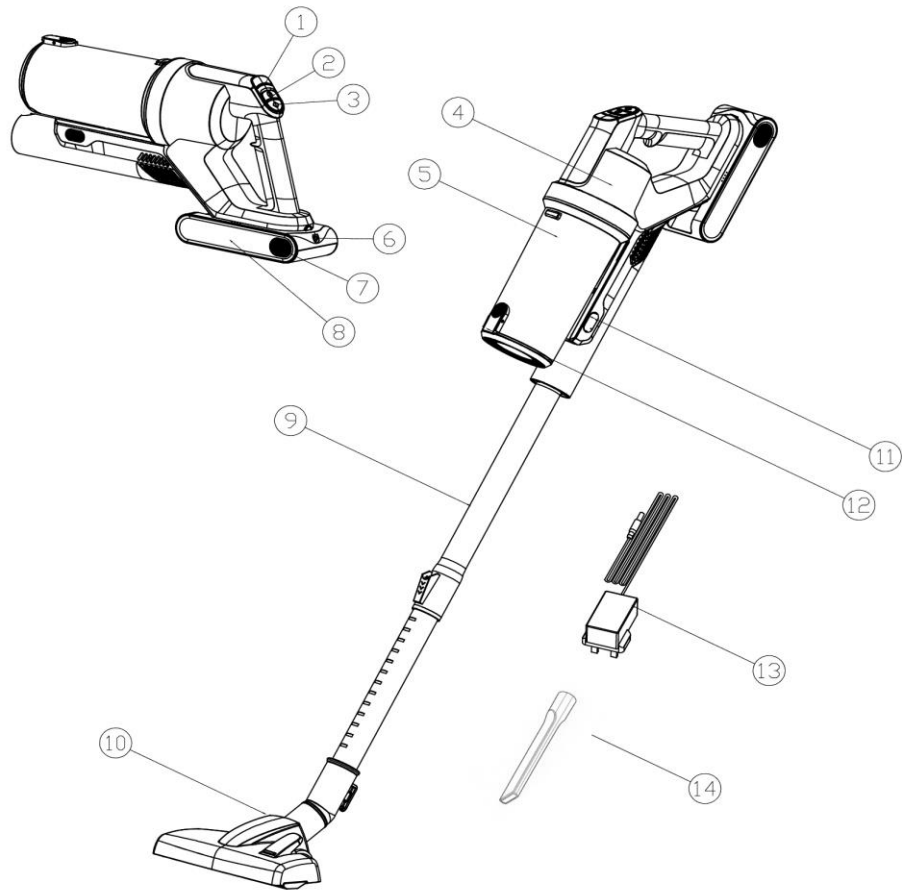

- | | |
|-------------------------|-----------------------------|
| 1. LED Light | 8. Battery |
| 2. ON/OFF Switch | 9. Tube |
| 3. Speed Control Button | 10. Brush |
| 4. Main Unit | 11. Dust Cup Release Button |
| 5. Dust Cup | 12. Dust Cup Cover |
| 6. Charging Port | 13. Charge |
| 7. Battery Release | 14. Crevice Nozzle |

Assembly

Assembling the Dust Cup Unit:

1. Place the filters into the dust cup. Twist the cone and align its pins with the grooves inside the dust cup.
2. Insert the filter onto the cone.

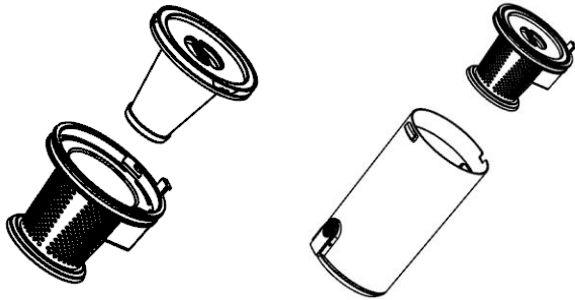

Assembling the Dust Cup with the Motor Unit:

1. Align the dust cup with the pins on the lower edge of the motor unit.
2. Twist the dust cup until a “click” sound is heard.

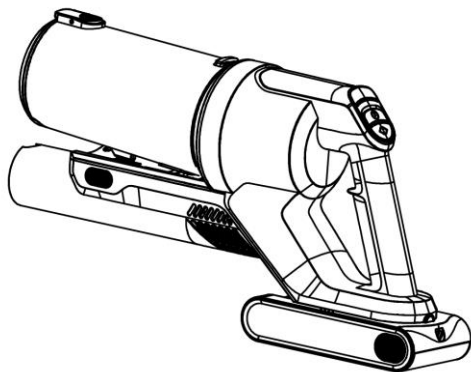

Assembling the Brush, Tube, and Main Body:

1. Insert the upper end of the brush into the lower end of the tube.
2. Insert the upper end of the tube into the suction mouth.



How to Assemble the Accessories

To the Main Unit:

Insert the crevice nozzle firmly into the main unit's port.

To the Tube:

Insert the crevice nozzle into the suction mouth. Refer to the illustration.

Suitable for cleaning sofa gaps, corners, stairs, keyboards, and other narrow areas.

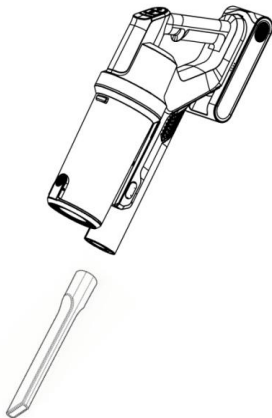

Using the Vacuum Cleaner

ON/OFF:

Press the ON/OFF button to start the vacuum cleaner. Press the button again to turn it off.

Cleaning and Storage

Emptying the Dust:

1. Press the release button on the side of the main unit to detach the dust cup.
2. Press the dust release button to empty the contents of the dust cup.

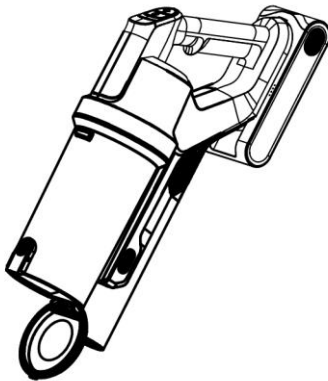

Cleaning the Dust Cup:

1. Press the release button on the side of the main unit.
2. Disassemble the dust cup and remove the steel mesh and sponge filter.
3. Both filters are washable. After cleaning, let them air-dry completely before reassembling.

Charging

Ensure the power source is stable and matches the voltage specified...

The charging port is located at the rear of the appliance.

While charging, the power indicator light flashes.

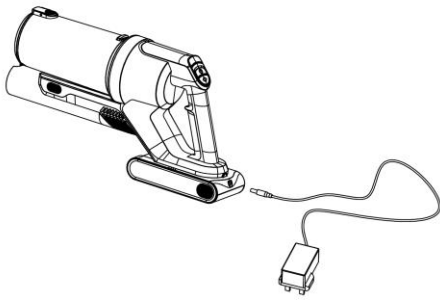

Installing/Removing the Battery Pack

Align the battery pack with the fixing slot and insert it.

To remove, press the battery release button and pull the battery pack backward.

