

Russell Taylors

i2 Product Manual





1. Before using this product, please read all the contents of this manual carefully and follow the steps of this manual to install the machine. Take good care of this manual. If you transfer the product to a third party for use, please attach this instruction manual with the machine. Any operation not in accordance with the instructions may cause damage to the product or serious personal injury. This product is only suitable for use in conventional household environment, not for industrial or outdoor use.
2. This product is not intended for use by persons with physical, sensory or intellectual disabilities or those lacking experience and common sense (including children), unless supervised or directed to ensure its safe use.
3. Do not touch the plug or any live part of the product with wet hands to avoid the danger of electric shock.
4. If the charger or plug is damaged, stop using it. Please call the company's professional maintenance personnel to replace, in order to avoid harm.
5. Please keep the airflow channel and moving part of the product away from long hair, loose clothing, fingers and other parts of the body. Do not point the vacuuming tube, attachment suction head or tools at your eyes and ears, or put any of them in the mouth.
6. When you find electric leakage or motor temperature is too high and abnormal sound, such as overheating of the motor, abnormal sound, peculiar smell, weak suction, etc., you should immediately stop using and call the company's professional maintenance personnel.
7. Please use the charger specialized provided by our company for you to charge; Other types of chargers can cause battery failure or extreme thermal effects.
8. If you do not use the product for a long time, you should turn off the power and unplug the charging socket. After using the machine, please clean the dirty water tank in time, keep the ventilation path unblocked, avoid suction drop, motor heating caused by blocking, so as to affect the service life of the washing machine.
9. After using the machine, please keep it in a dry place. The damp place will affect the insulation and service life of electrical appliances. Electrical parts of machine, which can not be soaked or washed.
10. Please check the unblocked condition of the suction nozzle regularly. If there is blockage, please remove it in time to avoid the reduction of suction caused by blockage and affect the performance of the machine.
11. Please make sure that the machine is off state before replacing the roller brush.
12. When the machine breakdown, do not repair by yourself, please call our after-sales department for help.
13. All the technical and other data reflected in the product manual shall be obtained by our company or the designated third party testing company, and the final interpretation right belongs to our company.

1. This product is suitable for hard floor indoor environment, including waxed floor, stone grinding floor, rubber floor, marble floor, granite floor, terrazzo floor, solid wood floor, composite floor, bamboo floor and various mirror tiles, porcelain tiles and other flat surface. If the product is used on uneven surface, it may not achieve the best effect.
2. Do not use this product near or on the surface of flammable and explosive objects, which may cause fire and risk of explosion.
3. Do not use this product near the fireplace and heater, in order to prevent the machine shell from changing shape.
4. Do not suck in high-temperature substances (extinguished cigarette ends, matches, hot ashes, etc.), ultra fine substances (such as lime, cement, wood chips, gypsum powder, ash, charcoal powder, etc.), dangerous substances (such as solvents, detergent, etc.), chemical substances (such as acid substances, detergents, etc.), and other substances with uncertain physical properties.
5. Do not use the machine to absorb detergent, kerosene, gasoline, alcohol, paint, perfume, etc. These liquids may cause a short circuit, fire or explosion of the machine.
6. Do not use the machine to absorb the toner used in the laser printer and copier. These objects may cause fire or explosion.
7. Do not use the machine to absorb sharp objects, such as glass fragments, small toys, pins, paper clips, stones, sapphires, large pieces of paper, etc., these objects may cause blockage and damage of the machine.
8. Do not use the machine to absorb any burning or smoking objects, such as extinguished heat source ashes, burning cigarette butts or matches, etc.
9. Stains with strong grease, strong viscosity or strong dyeing, such as shoe polish, paint, pigment, etc., are not within the scope of this product use.

>>>About Cleaning Solution

1. If a large amount of cleaning solution is added, it will produce more foam when used, which may penetrate into the motor and cause danger.
2. Clean according to the usage instructions. It is recommended to use cleaners that have low amount of foam produced.
3. Cleaners should be kept out of reach of children. If the cleaning solution accidentally gets into your eyes, rinse thoroughly with water. In case of accidental ingestion, seek medical attention immediately.
4. Follow local environmental regulations when handling sewage and cleaning solutions.

>>>About the machine

1. Do not dismantle or assemble the closed machine by yourself. There is no self-maintenance part in the machine. Do not attempt to change the performance of the machine, or it will cause danger.
2. The use of voltage which does not correspond to the specifications of the product will damage the motor, more likely to cause injury to the user.
3. The correct rated voltage is marked on the rating label.
4. When cleaning the stairs, be more careful to prevent falling.
5. Do not shake the machine up and down or violent collision, to prevent sewage entering the motor.
6. When the motor is working, please do not lift or carry the electrical appliance, do not tilt the machine to one side or flat, to prevent sewage from entering the motor.
7. In order to prevent tripping, the machine should be placed against the wall after use.
8. If the cleaning bucket and dirty water tank are not properly installed, do not use.
9. Do not place any small objects in the air outlet, do not block the air outlet, take away all small objects that may interfere with the smooth air flow of the air outlet, to prevent overheating of the machine.
10. Do not wet the fuselage, otherwise there may be fire and electric shock accidents due to short circuit of the machine.

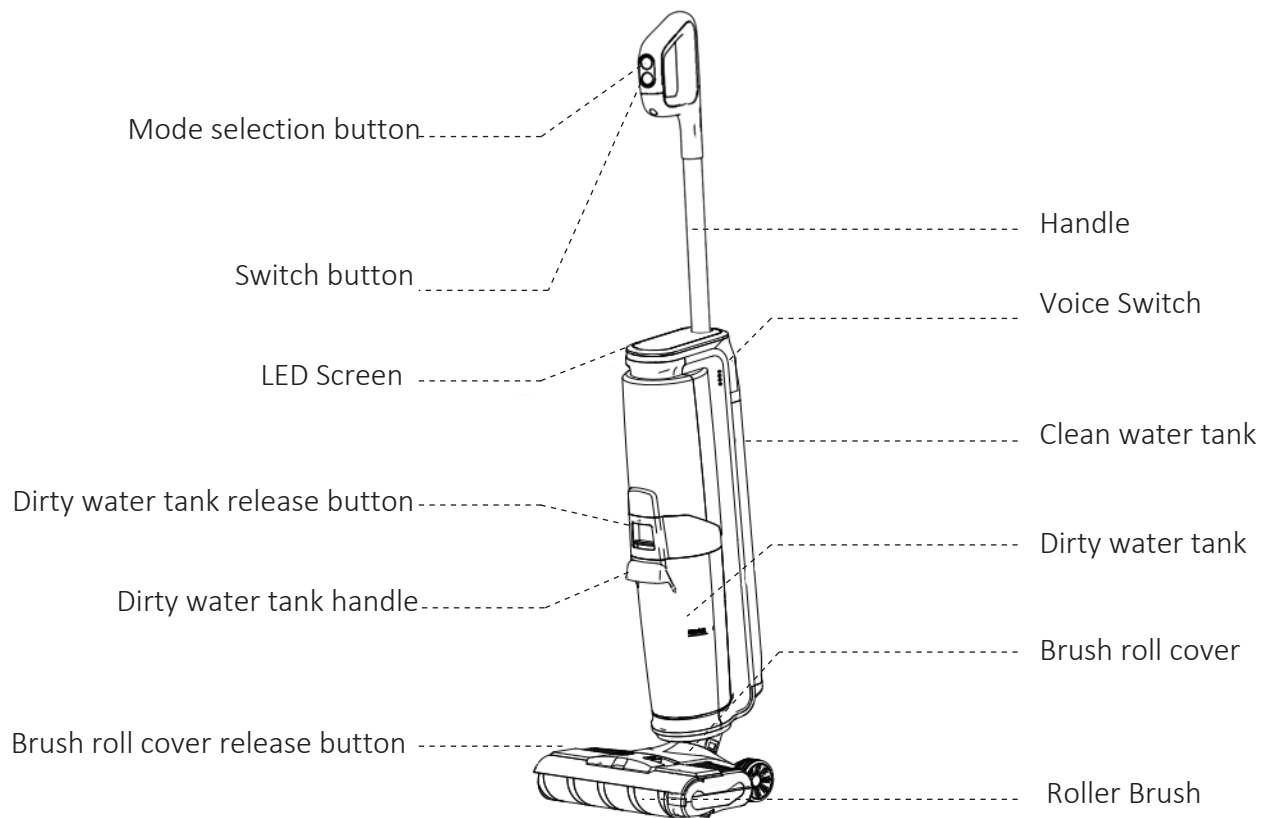



Machine body



Cleaning brush

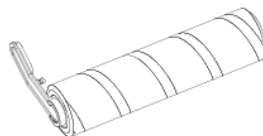

Roller brush

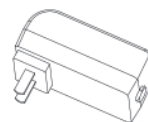

charger



Filter

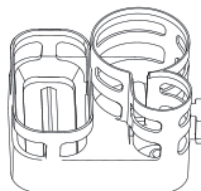

Roller bracket

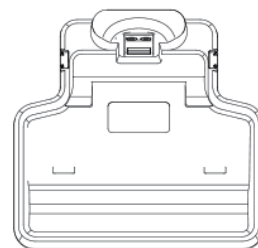

Charging base

LED SCREEN



Self-cleaning mode



Water absorption mode



Auto Mode

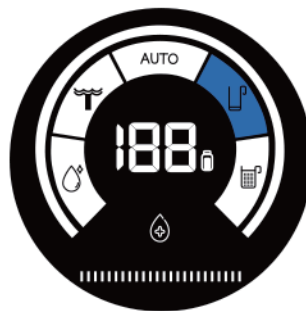

Clean tank is empty

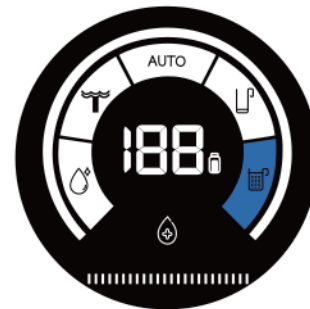

Waste tank is full

Handle installation instruction

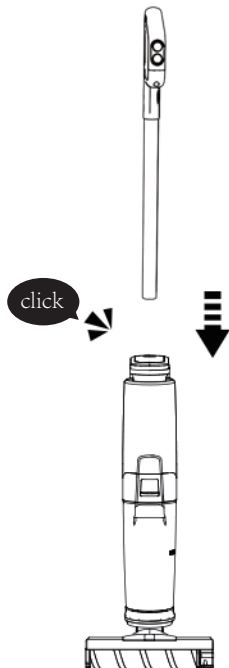

Insert the end of the handle vertically into the fuselage jack. After hearing the click, ensure that the handle is firmly and securely installed.



To disassemble, please press the shrapnel with a hard object into the hole on the back of the fuselage, and pull out the handle of the machine upward.

Cleaning tank instruction



To remove the cleaning tank, hold the fuselage with one hand, push the tank button with the other hand, and then pull out to remove the barrel.



To install the cleaning tank, firstly put the bottom of the cleaning tank into the support position of the fuselage, And then gently push the cleaning tank, after hearing the click, the installation is successful.

Dirty water tank instruction

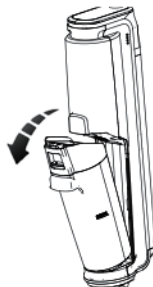

To remove the dirty water tank, hold the fuselage with one hand, push the slop tank button with the other hand, and then pull it out.



To install the dirty water tank, firstly put the bottom of the dirty water tank into the support position of the fuselage, and then gently push the dirty water tank. When the click is heard, the installation is successful.

Roller brush cover disassembly instructions

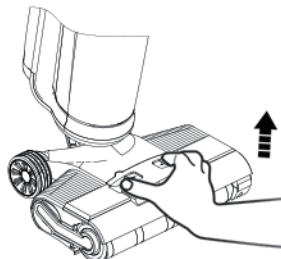

To remove the rolling brush cover, first apply your finger to the position as shown in the picture and press the release buttons at both ends with your thumb and forefinger to lift the rolling brush cover.

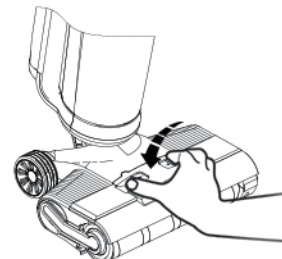

When installing, firstly apply your finger to the position as shown in the picture and press the release buttons at both ends with your thumb and forefinger at the same time. Press down and hear the click sound, the installation is successful.

Roller brush parts disassembly instructions

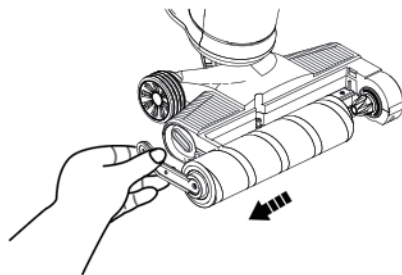

To remove the roller brush, pull the left roller handle with your fingers and remove it.

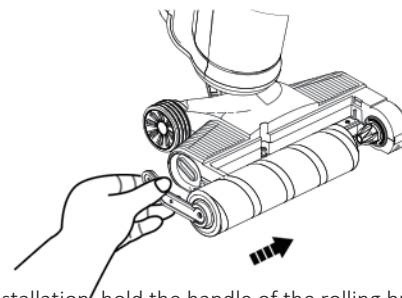

During installation, hold the handle of the rolling brush by hand, align the right side of the rolling brush with the right end cover, and then put the left handle of the rolling brush into the slot, and the rolling brush can be installed success-fully.

Before First Use

Before use, please check whether your floor washer has electricity. If not, please charge it for 3-4 hours before using it with a fully charged battery.

The startup mode is intelligent by default. You can select a mode based on actual requirements.

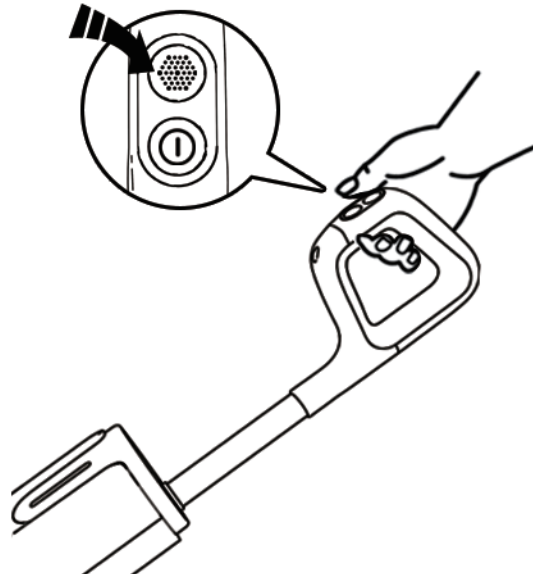

Press the mode button to switch between intelligent mode and water absorption mode. Select the required mode to automatically enter the working state.

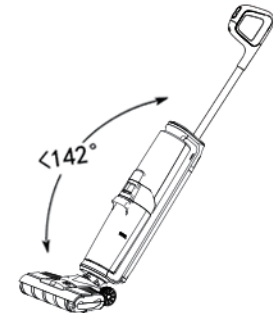

The machine has an upright switch, please tilt after starting the machine, but do not tilt the machine more than 142 degrees, so as not to cause water leakage.



After using the machine, it is recommended to place it vertically on the charging dock specially provided for you.

Adding water into the tank.

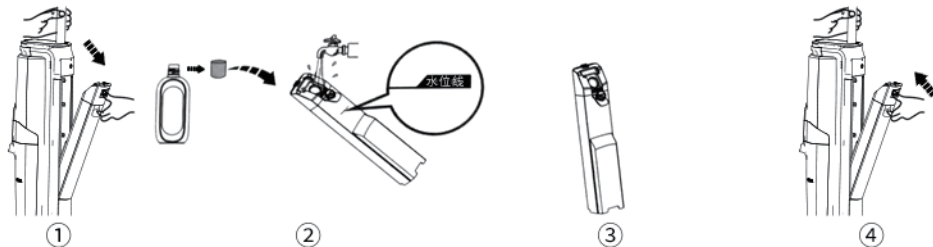

Gently press the release button to remove the cleaning tank (Pic. 1).

Open the top cover of the water bucket and add clean water (below 60 degrees) to the water level. For deep cleaning, you may pour a small amount of floor detergent.

Close the top cover of the cleaning bucket to ensure that it is tight and not loose (Pic. 3).

Place the water tank back into the machine.

Pouring out waste water.

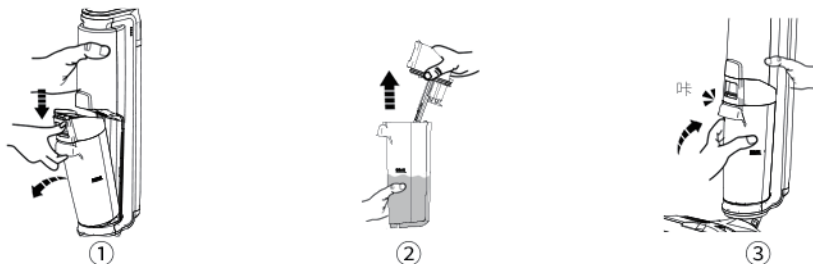

Gently press the dirty water tank button to remove the dirty water tank (Pic 1)

Hold the bucket with one hand and pull out the dirty water cover with the other hand (Pic 2).

After the sewage is dumped, install the dirty water tank back to the fuselage, and the installation will be successful when the click is heard (Pic 3).

Charging the machine.

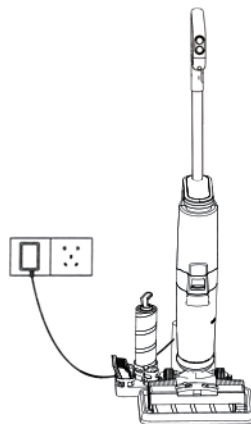

First, put the machine into the charging base, connect one end of the charger to the charging base, and the other end to the home socket; The power cord can be folded up when no charge is required. When charging, please keep the machine upright and close to the corner to avoid tripping and other injuries.

Note

If the product is not used for a long time after purchasing, please charge the battery for 3 hours every 3 months by using the charging base specially provided by the company (no need to fully charge the battery).

Safe disposal of lithium battery.

- ▶ When batteries in the appliance contain materials that harmful to the environment, they must be removed from the appliance before discarded.
- ▶ Power off the appliance before removing the battery.
- ▶ Dispose the discarded battery safely and properly, and do not throw it into fire, water, or soil.
- ▶ If the leakage of the waste battery touches the skin or clothing, rinse with water to avoid skin discomfort and seek medical advice immediately.

Clean the machine

It is recommended that you have regular maintenance on its components , in order to avoid the using function of machine

! Note

It is recommended that you have regular maintenance on its components , in order to avoid the using function of machine

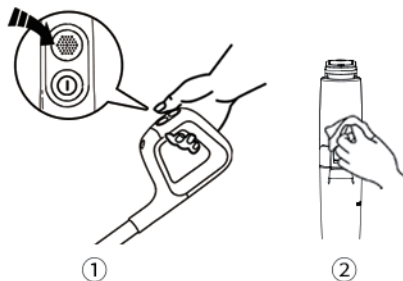

1. Please stop the machine before cleaning (Pic 1).
2. Scrub with water or neutral detergent, be sure to wring out the cleaning cloth before scrubbing, do not let water get inside the electrical parts of the appliance. (Pic 2).

Clean the dirty water tank

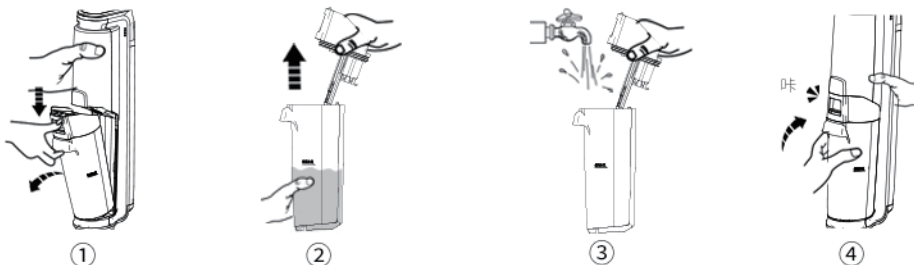

1. When the dirty water tank is full, the machine will automatically power off, with the prompt of display screen and voice.
2. If there is stubborn dirt on the inside wall of the dirty water tank, please clean it directly with a small cleaning tool.
3. After cleaning, close the cover of the dirty water tank and install it back to the machine. After hearing the click, it will be installed in place.

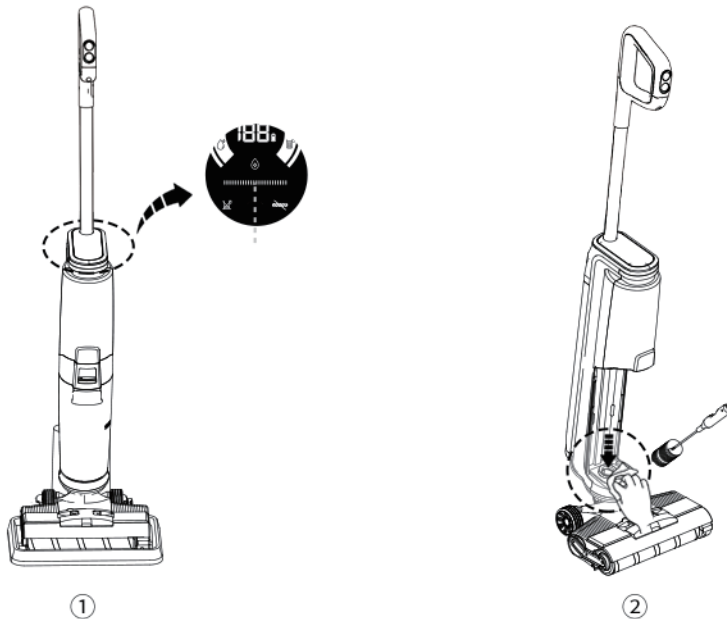
Clean the dirt sensor

1. There is no obvious dirt on the ground, but when the cleaning strip flashes in red, the dirt sensor may be blocked by dirt (Pic 1)

2. Remove the dirty water tank, wipe the dirt sensor in the pipe with a damp cloth, or clean the internal dirt of the pipe with a cleaning tool before reuse (Pic 2).

Clean the dirty water tank cover

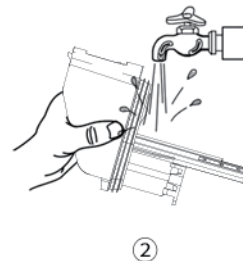
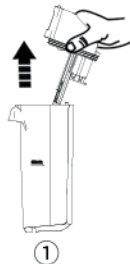

- 1.If the dirty water tank is blocked, clean it in time.
- 2.Remove the top cover of the dirty water tank (Pic. 1) and clean with water (Pic. 2).
- 3.After cleaning, load the dirty water tank.

Clean the filter

- It is recommended to clean and dry the filter after each use to keep it clean and tidy.

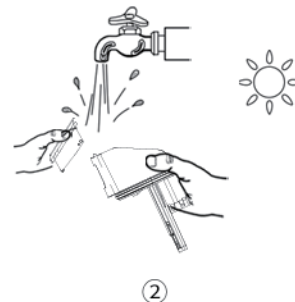
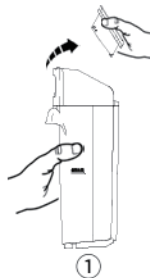

- 1.Remove the filter from the top of the dirty water tank (Pic 1).
- 2.Remove and wash with clean water (Pic. 2), dry thoroughly and put into the dirty water tank.

Self-Cleaning



Note

It is recommended that you have regular maintenance on its components ,

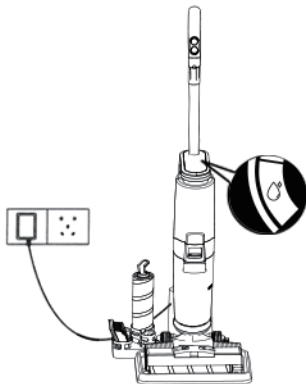

- 1.Put the machine back to the base after use, press self-cleaning button to start self-cleaning.
2. When the self-cleaning indicator blinks, press self-cleaning button on the screen to start self-cleaning;
- 2.After the self-cleaning, the machine continues to enter the charging state.

Clean the roller brush cover

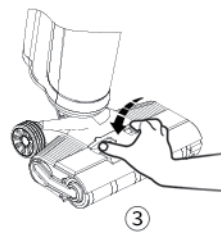
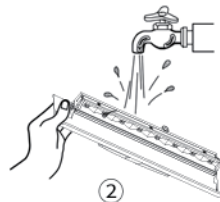
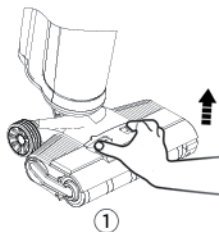

- 1.To remove the roller brush cover, firstly put your finger on the position as shown in the picture and press the release buttons at both ends with your thumb and forefinger to lift the roller brush cover upward and take out the roller brush cover (Pic 1)
- 2.After removal, rinse with water until clean (Pic 2).
- 3.After cleaning, install the roller brush cover into the base (Pic. 3).

Clean the roller brush

- It is recommended to clean and dry the roller brush after use to keep it clean and tidy.

Note

If residual stains are found at the mouth of suction nozzle, please wipe with wet cloth, do not wash with water.

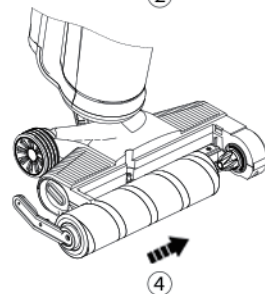
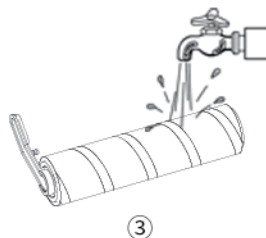
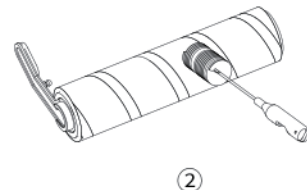
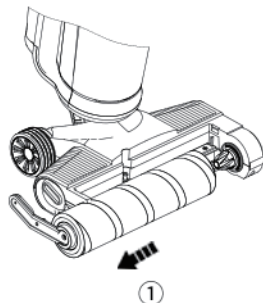

1. Pull up the handle on the left end of the roller brush and remove it (Pic 1).
2. Remove the roller brush handle and use the roller brush cleaning tool to remove tangled hair or debris on the brush head (Pic 2).
3. Then clean the roller brush with water (Pic. 3).
4. After cleaning, install the roller brush handle firstly, and then install the roller brush inside the ground brush. When installing, firstly please roll the right side of the brush (no protruding structure) into the right slot, and then push the left side (one end with handle) along the left and right slots. (Pic 4).